



Description

Use and brief introduction

The product belongs to class I, type B. Non AP or APG device, continuous device. And possesses application part.

YA-01E is electric operated operating table. It is microprocessor controlled and its function parameters are programmable with special program.

The operating table is widely used, easy to operate and adjust with reliable performance, which is a ideal table for different hospital

General content

Basic data

The technical data should look at Form 1

Form 1: basic data unit:mm

| Basic data Model | length | Width | lowest height of tabletop | Distance of elevation |
|---------------------|---------|-------|---------------------------|-----------------------|
| | L | B | h min | S |
| YA-10E | ≥2100mm | 550mm | 700mm | ≥250mm |

Standard table configuration includes

| NO. | Item | quantity | NO. | Item | Quantity |
|-----|--------------------|----------|-----|-------------------|----------|
| 1 | Anaesthesia screen | 1 piece | 9 | Foot plate | 2 pieces |
| 2 | Shoulder support | 2 pieces | 10 | Long Fixing clamp | 2 pieces |
| 3 | Body support | 2 pieces | 11 | Fixing clamp | 7 pieces |
| 4 | Arm board | 2 pieces | 12 | Hand Remote | 1 piece |
| 5 | Leg support | 2 pieces | 13 | Power line | 1 piece |
| 6 | Head plate | 1 piece | 14 | oilcan (with oil) | 1 piece |
| 7 | leg plate | 2 pieces | 15 | User Manual | 1 piece |
| 8 | Mattress | 1 Set | | | |

Gross weight、net weight、 volume

Gross weight:270kg, net weight:220kg, Volume (long×width×height) 2100mm×720mm×730mm.

Safe work loading capacity of YA-10E

The safe working load of the table is 200 kg.

Commissioning

keeping

Inside its original packing the operating table may be exposed for a period of 15 weeks to environmental conditions within the limits of :

| | |
|----------------------|------------------|
| Ambient temperature | 10℃~40℃ |
| atmospheric humidify | ≤80% |
| Atmospheric pressure | 700 hPa~1060 hPa |

- ❖ The table should be kept in a clean place, never put in the places where influenced by atmospheric pressure, temperature, humidity, aeration, sunshine, or dust and sulfur.
- ❖ The table should be kept separately from chemicals.
- ❖ stock in a ventilated place.

Transportation

Upon leaving the factory, the operating table are positioned fit for transportation. In case of further transportation at a later date, we recommend to adjust the operating table into the same position.

- ❖ In order to transport the operating table, adjust seat and back section in to horizontal position.
- ❖ Remove the head and leg plates, and detach other accessories.
- ❖ Adjust the table-top into minimum height.

Attention before using

- ❖ Please Check the switch, and be sure they can work.
- ❖ Please confirm all the power line are connected right and safely.
- ❖ Do not pull or push the shields of back and leg section joints. Check during adjustment that there is no foreign obstacles between shields.

Using adjust

- ❖ Adjustment of leg plate

The electric leg plate part is controlled by the hand remote. The leg plate is gas spring control. Press down the gas spring, then move the leg plate to the position you need.

- ❖ Fixing of accessories

There is rail on the both side of the table, you can use the fixing clamp the set up all the accessories.

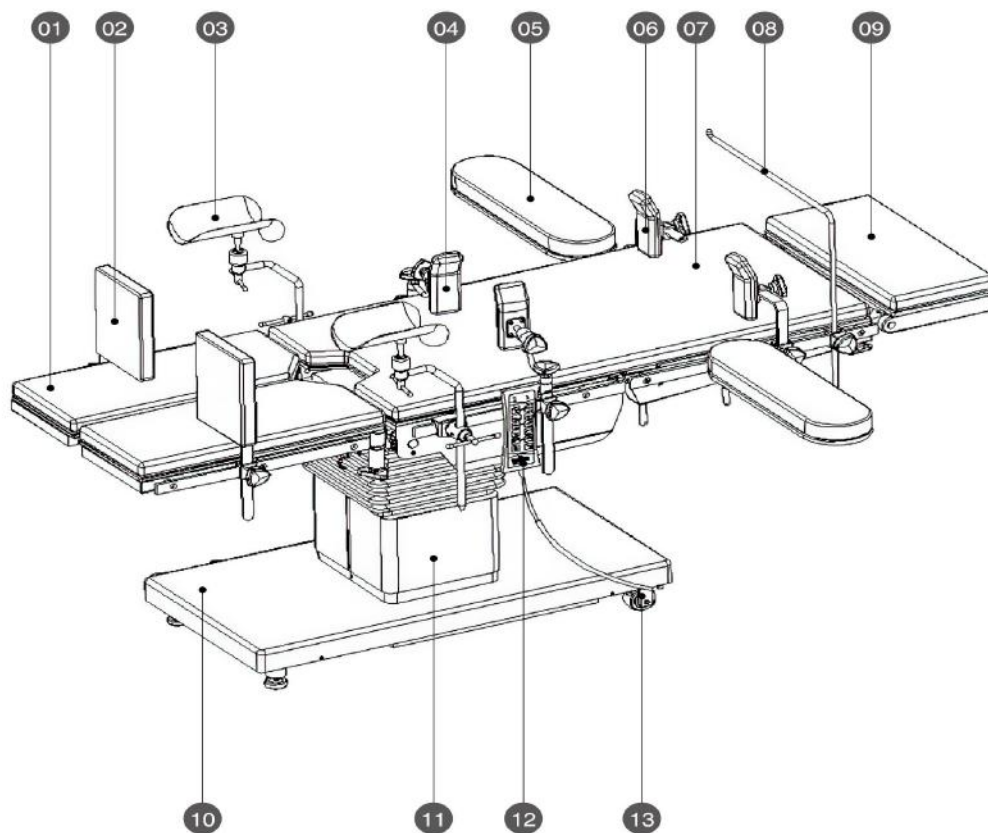

Product information

The operating is formed by head plate and back plate, waist plate, buttocks plate and leg plate

1-Leg plate

2-Foot support

3-Leg support

4-Waist plate

5-Arm support

6-Shoulder support

7-Back plate

8-Anesthesia screen

9-Head plate

10-Base

11-Column

12-Remote control

13-Castor

Features

- **Motorized tabletop** is constructed of three-sections and is 2100 mm long. The height can be controlled by the remote control, and the height can be adjusted according to the needs of the doctor.
- **Column** supports tabletop and includes electrical wiring and master computer. These components are enclosed by three telescoping plastic or optional stainless-steel column shrouds. The shrouds are of two-piece construction for service accessibility.
- **Base** structure is stainless steel. Four swivel casters, located inside the base cover, facilitate table movement.
- **Universal Foot pedal Control** is ergonomically designed, and is the primary interface for table operation. It is more convenient for doctors to control the operating table .



Universal Foot pedal Control

Foot Control Touch Pads for:

- HEIGHT UP/DN
- TILT LEFT/RIGHT
- BACK UP/DN

- LEG UP/DN
- SLIDING

TABLE OPERATION

Press the desired position touch pad on the remote control or use the optional foot control to articulate the tabletop (refer to Operator Manual).

The following pre-operative actions must be completed before the table can be used

No objects exist that affect the operations;

- Confirm if all the power lines are connected well, the switch is in "0" condition;
- Move the table to the right place you need;
- Connect the foot control with the table;
- Please check the power supply before turning it on
- Lock the base of the table;
- Fix up the head plate, leg plate and accessories according to the picture.
- The table adopts short-time work, attention: never press one button over 2min.

TABLE MOTION

Ranges of table motion are as follows and are illustrated on the other page

- **Height** 28" to 38"(700-950mm)
- **Back Section Motion** UP: 70° ; DOWN:30°
- **Leg Section Motion** DOWN: 90°
- **Head Section Motion (Manual)** UP: 55° ; DOWN: 90°
- **Kidney elevator mechanism** 120mm
- **Slide motion** 350mm
- **Leg section outwards** 90°
- **Loading Capacity** 200kg
- **Trendelenburg** 25°
- **Reverse trendelenburg** 30°
- **Lateral tilt left/right** 20° /20°
- **Kidney elevator mechanism** 120mm

Society of Automotive Engineers (SAE) Measurements are based on the metric dimensions; and are therefore approximate.

UTILITY REQUIREMENTS

Power Source: Battery/Electric-Powered Table

Line Power Input:

100/120/220/230-240 V ac (Jumper Selectable),

1 \emptyset , 50/60 Hz, 4 Amp

Environmental Conditions:

Temperature: 32-122°F (0-50°C)

Relative Humidity (RH): 20-80%

**CUSTOMER IS RESPONSIBLE FOR COMPLIANCE WITH
APPLICABLE LOCAL AND NATIONAL CODES AND
REGULATIONS.**



**WARNING – EXPLOSION HAZARD:
Table must not be used in the presence of
flammable anesthetics.**

Function of Hand remote

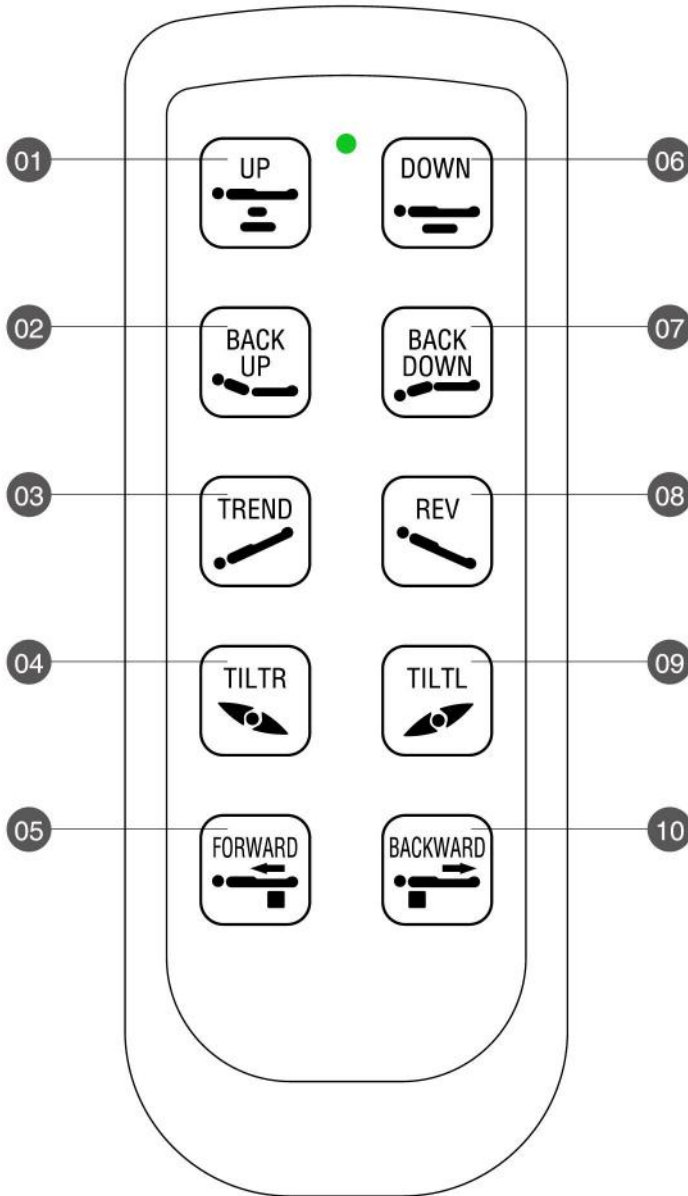

1 up

Raise the table top.

2 Back up

Raise the back plate.

3 TREND

Trendelenburg(foot down)

4 TILT

Tilt to the left.

5 Forward

Slide the table board

6 DOWN

Down the table top.

7 BACK DOWN

Lowers the back plate.

8 REVERSE

Reverse trendelenburg (head down).

9 TILT R

Tilt to the right.

10 Back Forward

Slide back the table board

Movements diagram

Tabletop elevation(up/down)

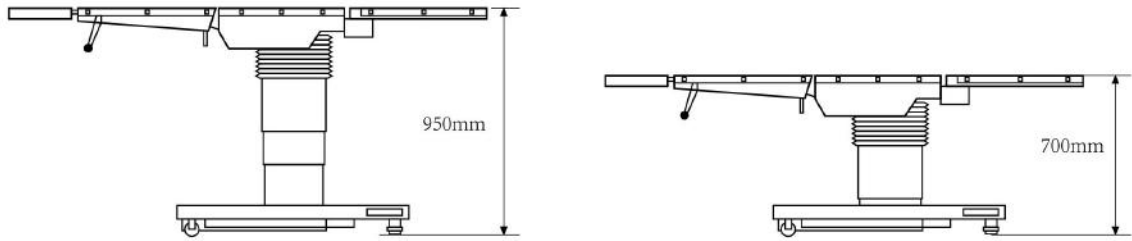

Head plate(up/down)

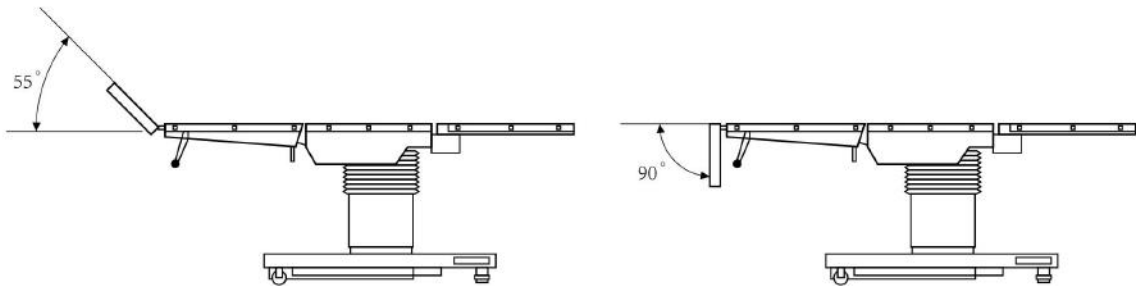

Back plate(up/down)

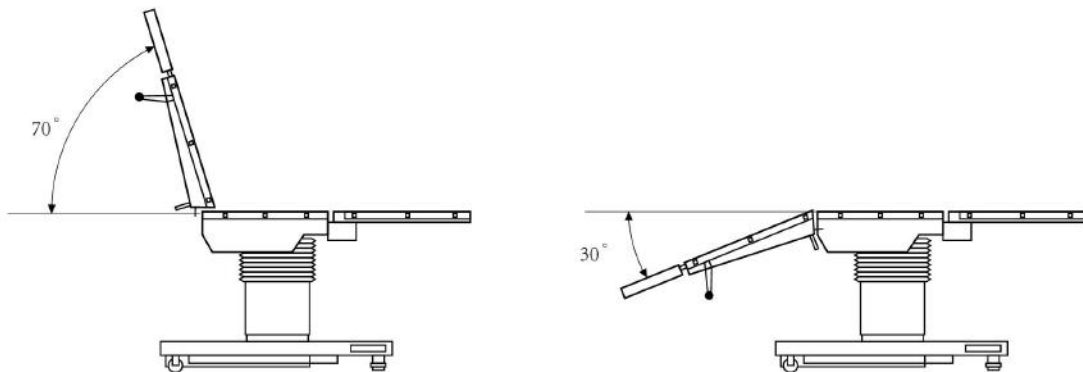

Leg plate(up/down)

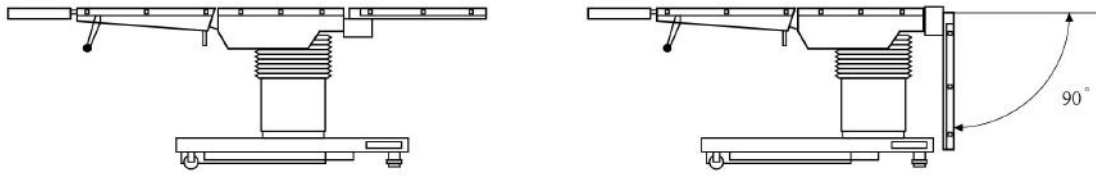

Trendelenburg/Anti-trendelenburg

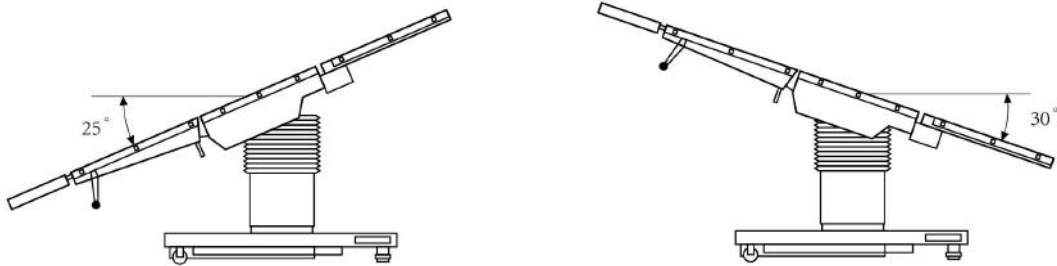

Horizontal sliding

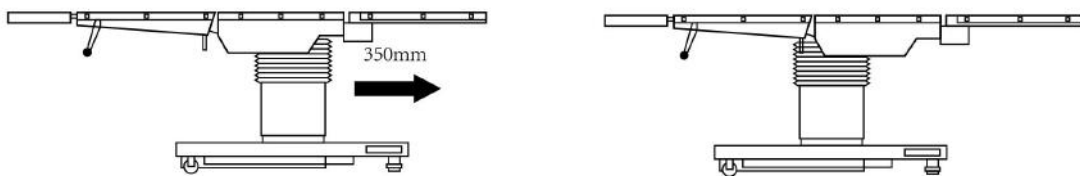

Leg plate outward

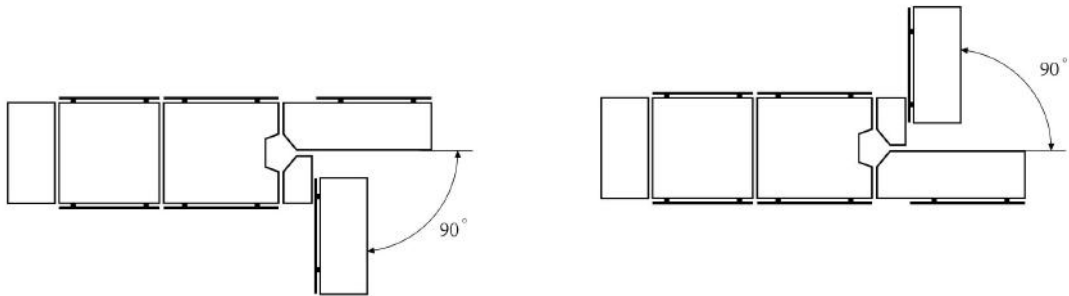

Kidney bridge(up/down)



Lateral tilt(left/right)

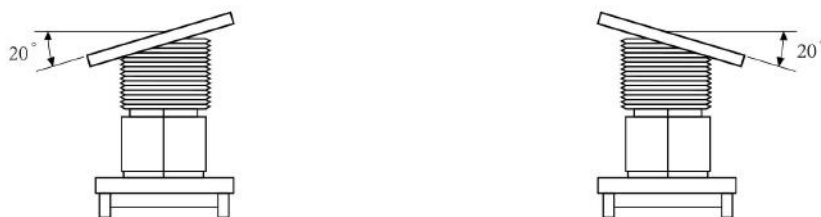

FOR FURTHER INFORMATION CONTACT
www.medikmedical.com | info@medikmedical.com

medik
+86 139 6223 1292